

PLAN OF SUBDIVISION

EDITION 1

PS917236H

LOCATION OF LAND

PARISH: TOONGABBIE SOUTH
TOWNSHIP: —
SECTION: —
CROWN PORTION: 133(P)

TITLE REFERENCE: VOL.12447 FOL.539
LAST PLAN REFERENCE: PS849256D (LOT 9)
POSTAL ADDRESS: 25 CASTLELKNOCK DRIVE,
 (at time of subdivision) GLENGARRY, 3854

MGA CO-ORDINATES: E: 462 900 ZONE: 55
 (of approx centre of land N: 5 780 270 GDA 2020
 in plan)

COUNCIL NAME: LATROBE CITY COUNCIL

VESTING OF ROADS AND/OR RESERVES

NOTATIONS

IDENTIFIER	COUNCIL/BODY/PERSON
—	—

NOTATIONS

DEPTH LIMITATION: DOES NOT APPLY

SURVEY:
 This plan is based on survey (PS849256D).

STAGING:
 This is not a staged subdivision.
 Planning Permit No. 2023/93

This survey has been connected to permanent marks No(s). —

In Proclaimed Survey Area No. —

EASEMENT INFORMATION

LEGEND: A - Appurtenant Easement E - Encumbering Easement R - Encumbering Easement (Road)

SECTION 12(2) OF THE SUBDIVISION ACT 1988 APPLIES TO ALL THE LAND IN THIS PLAN.

Easement Reference	Purpose	Width (Metres)	Origin	Land Benefited/In Favour Of
E-1	SEWERAGE	1.20	THIS PLAN	LOT 2 ON THIS PLAN

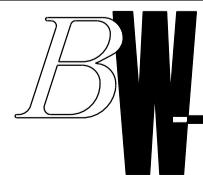
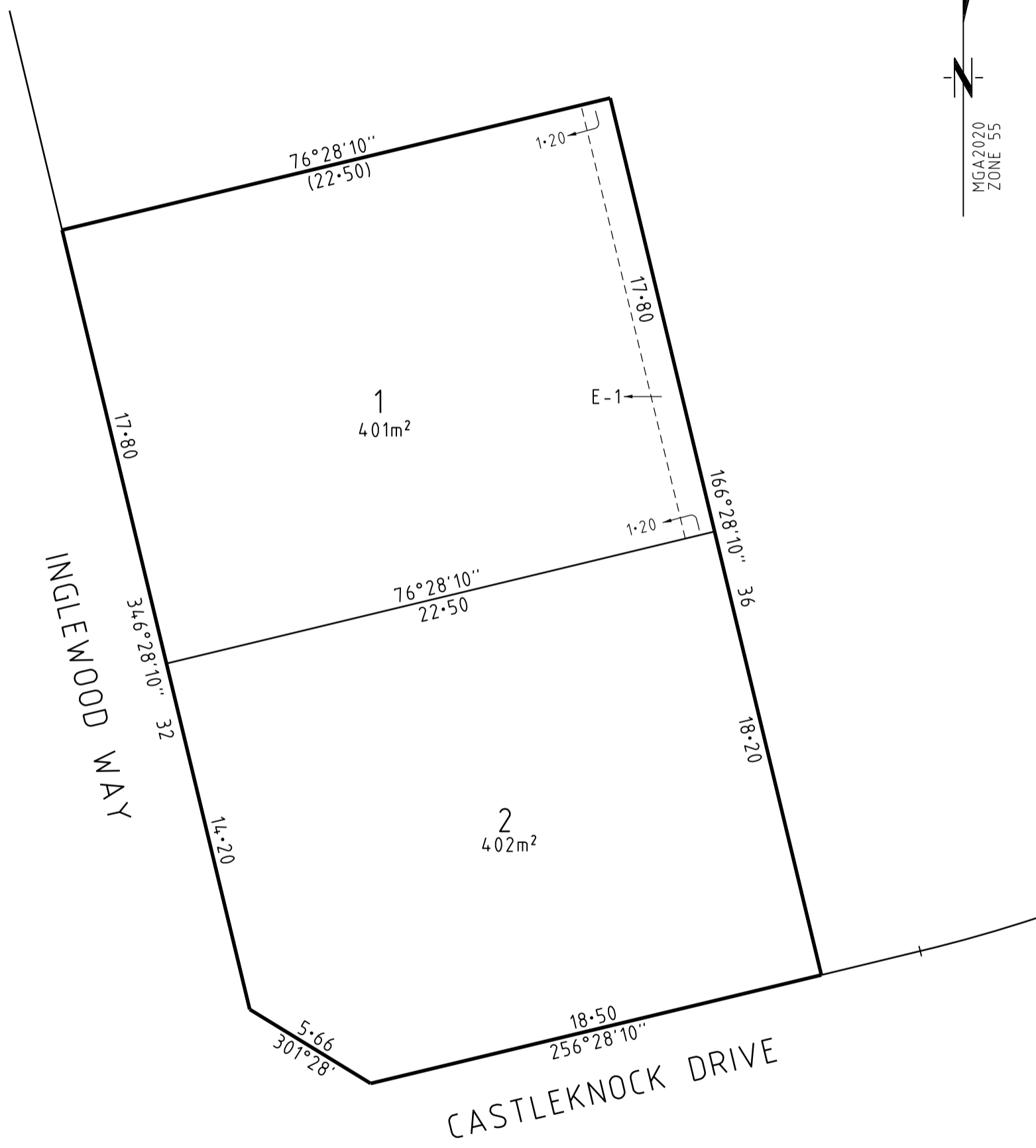

Beveridge Williams
development & environment consultants

Traralgon ph : 03 5176 0374
www.beveridgewilliams.com.au

SURVEYORS REF
2202670

SCALE
1 : 200

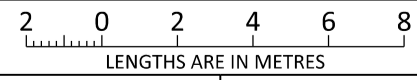

ORIGINAL SHEET
SIZE: A3

SHEET 2

LICENSED SURVEYOR: STEVEN JOHN WALLACE
VERSION 2, DATE: 12/10/2023