



ENERGY RATING REQUIREMENTS

REFER TO FIRSTRATES ENERGY RATING FOR FURTHER DETAILS

GENERAL
 ALL EXTERNAL DOORS TO BE SEALED
 ALL DOORS TO UNCONDITIONED ROOMS TO BE WEATHER STRIPED
 ALL EXHAUST FANS TO BE SEALED
 ALL CONSTRUCTION GAPS & CRACKS TO BE SEALED

ROOF / CEILING
 SHEET ROOF, FOIL SARKING OVER RAFTERS
 R3.5 BULK INSULATION BETWEEN CEILING JOISTS

WINDOWS
 ALUMINIUM IMPROVED FRAME AND DOUBLE GLAZING
 WITH U VALUE AND SHGF AS PER GLAZING SCHEDULE

EXTERNAL WALLS
 DOUBLE SIDED VAPOUR PERMEABLE REFLECTIVE FOIL
 FIXED TO EXTERNAL FACE OF STUDS,
 R2.0 BATTS BETWEEN STUDS, LINED INTERNALLY

FLOOR
 CONCRETE RAFT SLAB ON GROUND
 PROVIDE R1.2 INSULATION TO UNDERSIDE OF SLAB.

LEGEND

230 DOUBLE BRICK	
250 BRICK VENEER	
110 SINGLE BRICK	
90 TIMBER STUD	
SMOKE DETECTOR	
EXHAUST FAN	
ARTICULATION JOINT	
ELEC. SUB-BOARD	
HOT WATER SYSTEM	
DOWN PIPE	

Dwelling 5 Area Summary

Zone	m2	Sqr
Living Area	160.06	17.23
Garage Area	40.11	4.32
Alfresco Area	12.28	1.32
Portico Area	7.08	0.76
Total Area	219.53	23.63

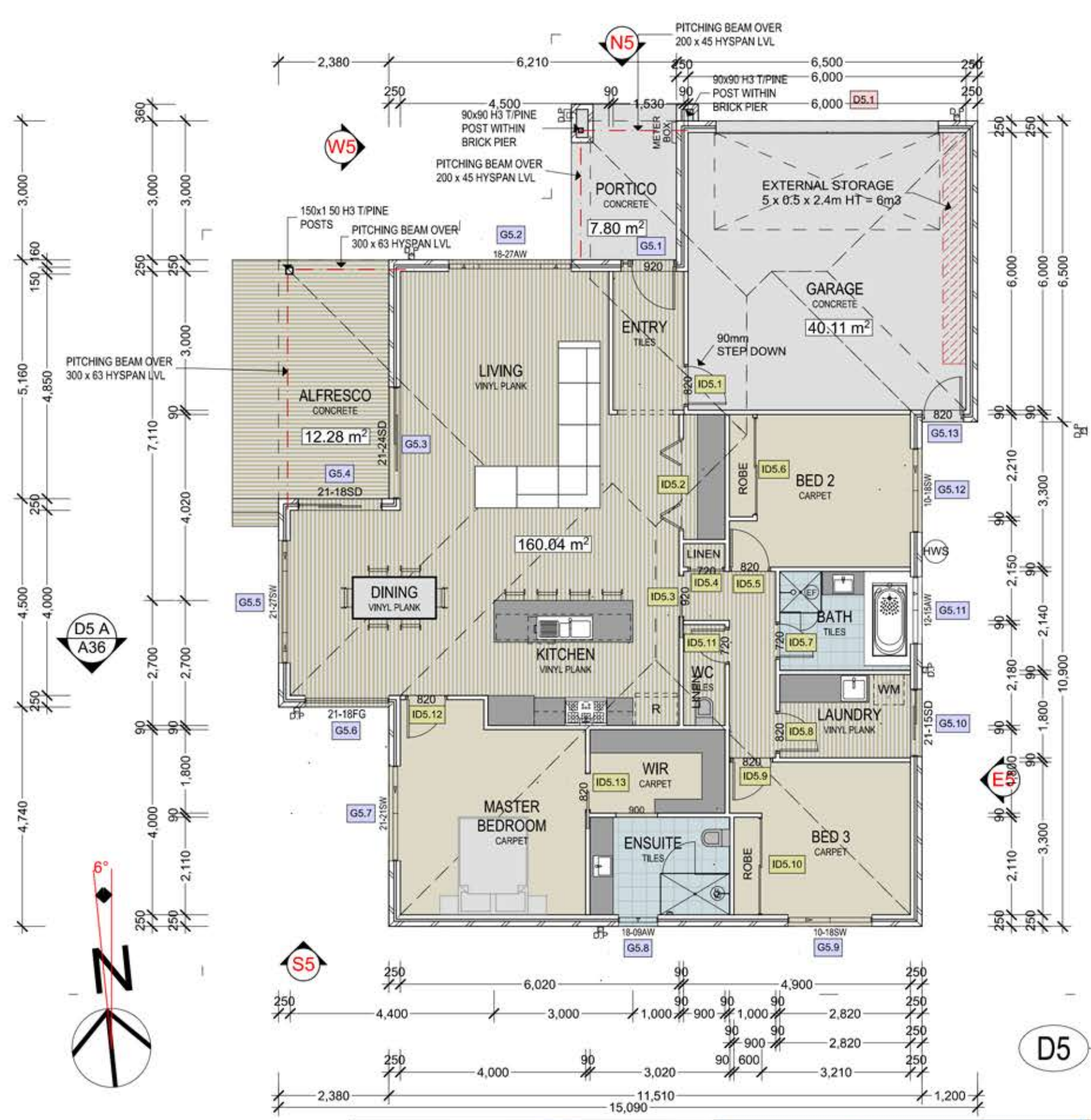

D5 FLOOR PLAN 1:100



PROJECT: PROPOSED MULTI-RESIDENTIAL DEVELOPMENT
 CLIENT: ALLURE LIFESTYLE GROUP
 LOT A P.S. 722083- McNULTY DRIVE TRARALGON VIC 3844

DRAWING TITLE: DWELLING 5 - FLOOR PLAN	BUILDERS SIGNATURE:	CLIENT SIGNATURE:	REVISION NUMBER: 01/03/19
DRAWN BY: S.McCLEMENTS			PROJECT NUMBER: L1847
CHECKED BY: S.McCLEMENTS			DRAWING NUMBER: A34

SCALE: AS NOTED @ A3