



ENERGY RATING REQUIREMENTS
 REFER TO FIRSTRATES ENERGY RATING FOR FURTHER DETAILS

GENERAL
 ALL EXTERNAL DOORS TO BE SEALED
 ALL DOORS TO UNCONDITIONED ROOMS TO BE WEATHER STRIPED
 ALL EXHAUST FANS TO BE SEALED
 ALL CONSTRUCTION GAPS & CRACKS TO BE SEALED

ROOF / CEILING
 SHEET ROOF, FOIL SARKING OVER RAFTERS
 R3.5 BULK INSULATION BETWEEN CEILING JOISTS

WINDOWS
 ALUMINIUM IMPROVED FRAME AND SINGLE GLAZING
 WITH U VALUE AND SHGF AS PER GLAZING SCHEDULE

EXTERNAL WALLS
 DOUBLE SIDED VAPOUR PERMEABLE REFLECTIVE FOIL
 FIXED TO EXTERNAL FACE OF STUDS,
 R2.0 BATTS BETWEEN STUDS, LINED INTERNALLY

FLOOR
 CONCRETE RAFT SLAB ON GROUND

LEGEND

- 230 DOUBLE BRICK
- 250 BRICK VENEER
- 110 SINGLE BRICK
- 90 TIMBER STUD
- S.M.O. SMOKE DETECTOR
- E.F. EXHAUST FAN
- A.J. ARTICULATION JOINT
- METER BOX
- ELEC. SUB-BOARD
- H.W.S. HOT WATER SYSTEM
- D.P. DOWN PIPE

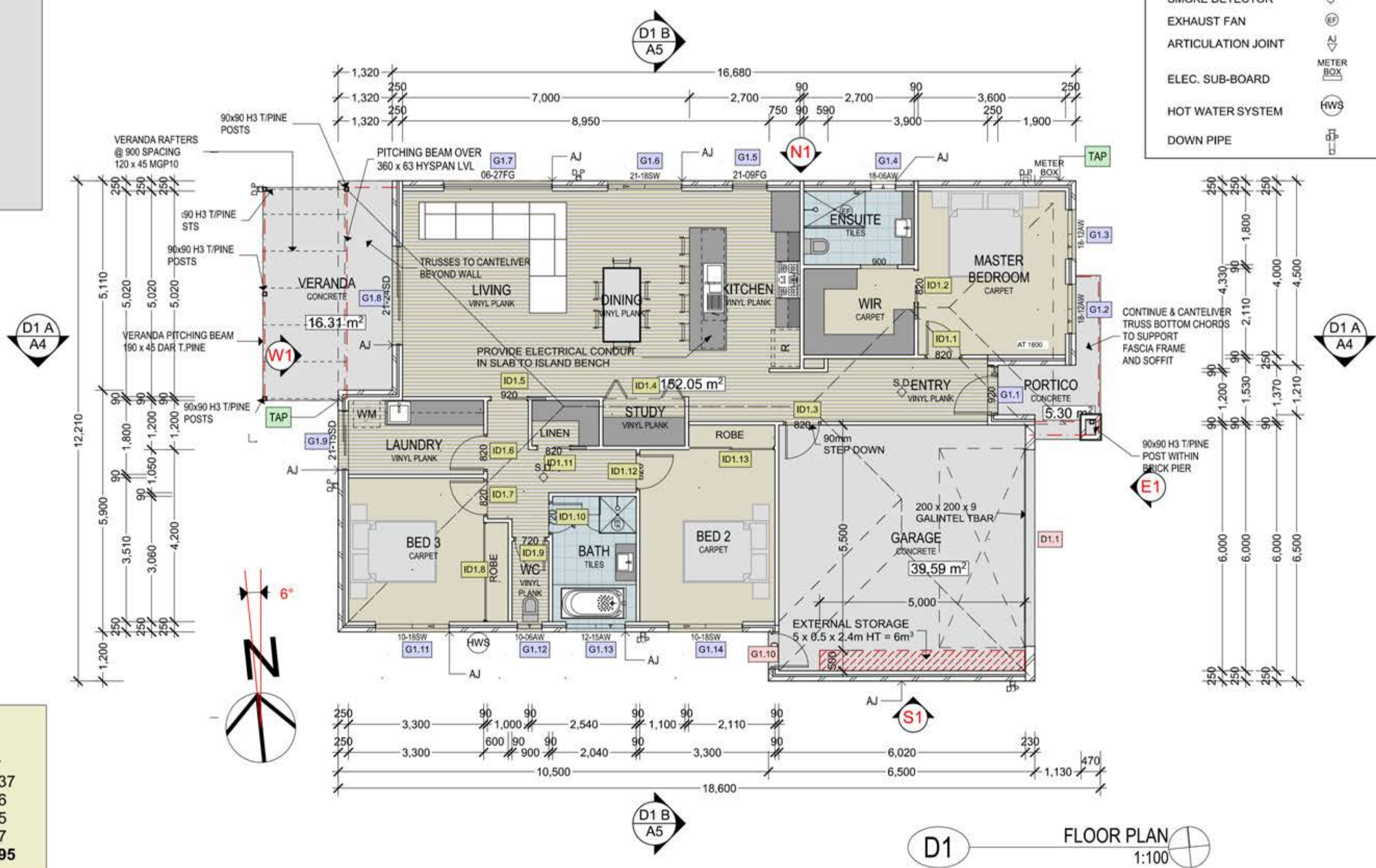

Dwelling 1 Area Summary

| Zone | m2 | Sqr |
|-------------------|---------------|--------------|
| Living Area | 152.05 | 16.37 |
| Garage Area | 39.59 | 4.26 |
| Alfresco Area | 16.31 | 1.75 |
| Portico Area | 5.30 | 0.57 |
| Total Area | 213.25 | 22.95 |

D1 FLOOR PLAN
 1:100



PROJECT: PROPOSED MULTI-RESIDENTIAL DEVELOPMENT
 CLIENT: ALLURE LIFESTYLE GROUP
 LOT A P.S. 722083- McNULTY DRIVE TRARALGON VIC 3844

DRAWING TITLE: DWELLING 1 - FLOOR PLAN
 REVISION NUMBER: 01/03/19

DRAWN BY: S.McCLEMENTS
 BUILDERS SIGNATURE: _____ CLIENT SIGNATURE: _____ PROJECT NUMBER: L1847

DATE: 10/3/2019
 SCALE: AS NOTED @ A3
 DRAWING NUMBER: A2